

Guangzhou AoZhong Fan Equipment Co.,LTD

CKS FangYuan Industry



CBA Utility Sets



国家防爆

CKS Fang Yuan Industry CBA Centrifugal Blowers are designed to provide efficient and reliable operation for commercial and extractive industry. Our products are manufactured with state of the art laser, forming, spinning and welding equipment and ensure our quality control testing to ensure trouble free start-up. Our CBA Centrifugal Blowers are including industry leading design features to ensure your ventilation equipment has the latest technologies available

Main feature with CBA Centrifugal Blower,,

- Concentric mount bearings with industry's highest cataloged bearing life
- Full mold, full welded structure
- Corrosion resistant, electrostatically applied and baked powder coatings
- Both belt and direct drive configurations
- Different motor brackets
- ISO9001:2000 controllable standard



Every CBA has been test for three different planes before package. Typical applications include:

- Stairwell Pressurization
- Restaurant Grease Exhaust
- Explosive gases emissions
- Mechanical equipment supporting

Engineers in Guangzhou AoZhong Fan Equipment Co.,LTD can assist you in improving the operational efficiency of the air movement in your system.

CBA Centrifugal Blower Model Number Code:

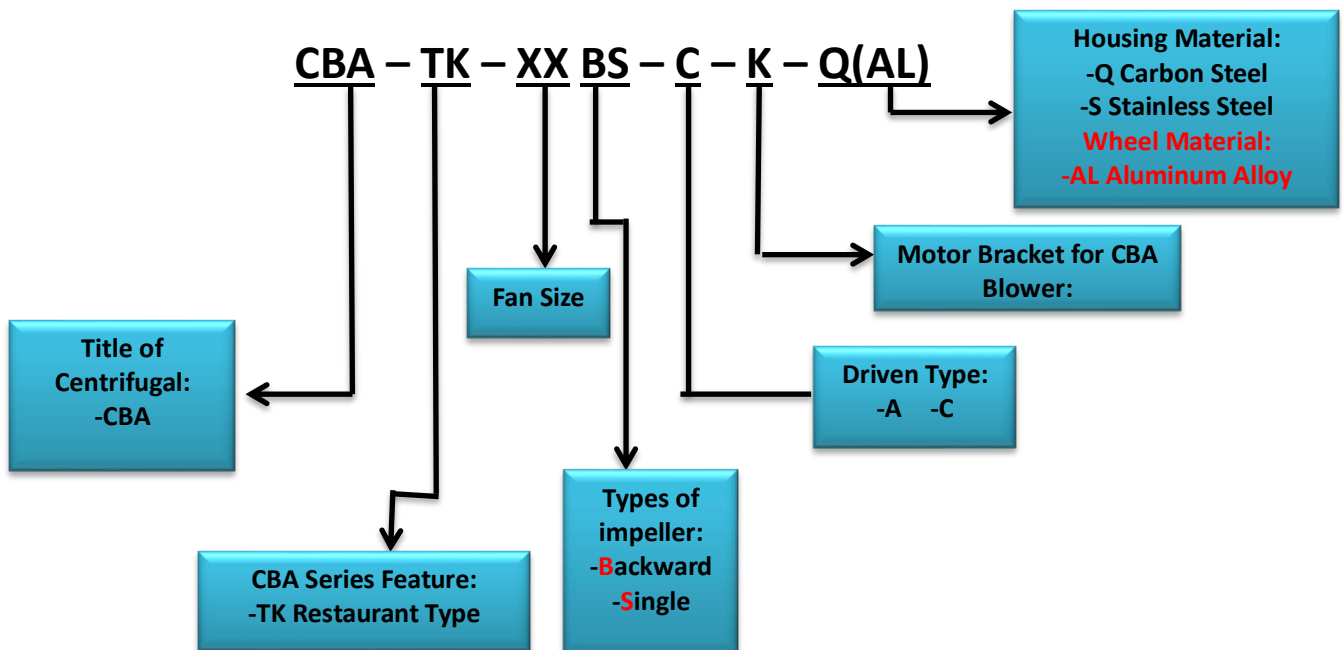

CBA Construction Details

CBA-TK Series: Direct drive, carbon steel and stainless steel are available. CKS Fangyuan leading design product with large air volume and medium pressure

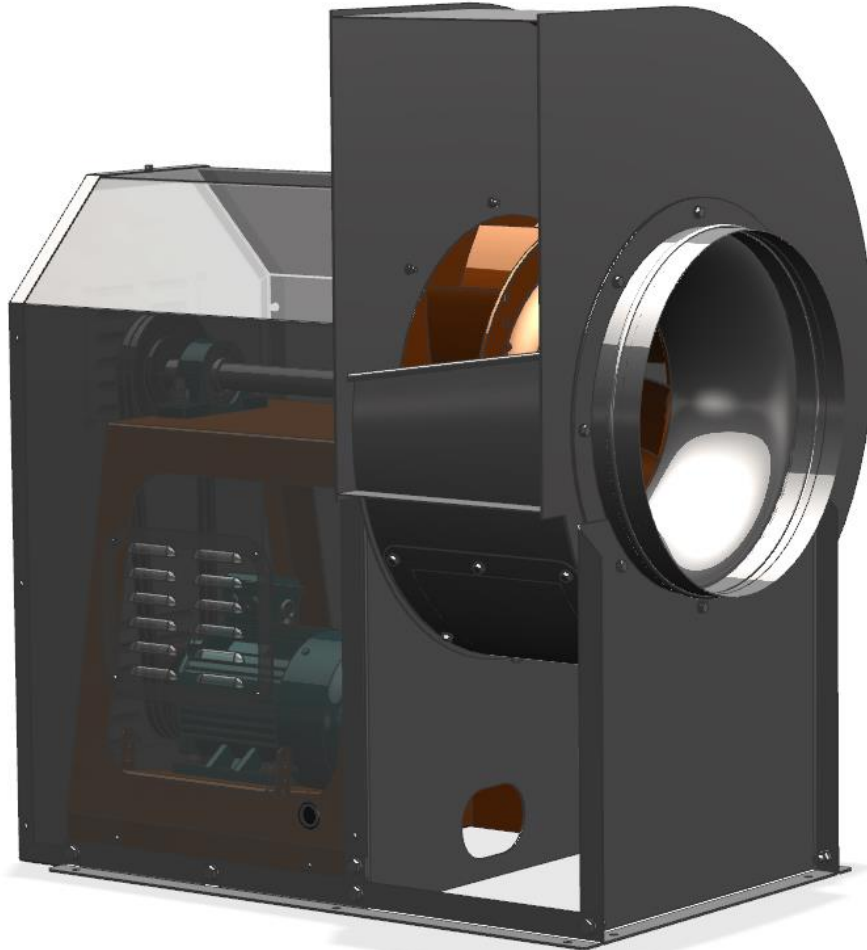

CW 0°
[UB]



CW 45°
[TAU]



CW 90°
[TH]



CW 135°
[TAD]



CW 180°
[DB]



CW 225°
[BAD]



CW 270°
[BH]



CW 315°
[BAU]



CCW 0°
[UB]



CCW 45°
[TAU]



CCW 90°
[TH]



CCW 135°
[TAD]



CCW 180°
[DB]



CCW 225°
[BAD]



CCW 270°
[BH]



CCW 315°
[BAU]

CBA-TK-XXBS Technical Data

CBA-TK-08BS

British Standard

Shaft dimension: **1"**
 Iron Case Thickness: **16ga**
 Motor Bracket Thickness: **14ga**
 Approximate Unit weight Thickness without motor: **121.25lb**

Metric System

Shaft dimension: **24mm**
 Iron Case Thickness: **1.5mm**
 Motor Bracket Thickness: **2mm**
 Approximate Unit weight Thickness without motor: **55kg**

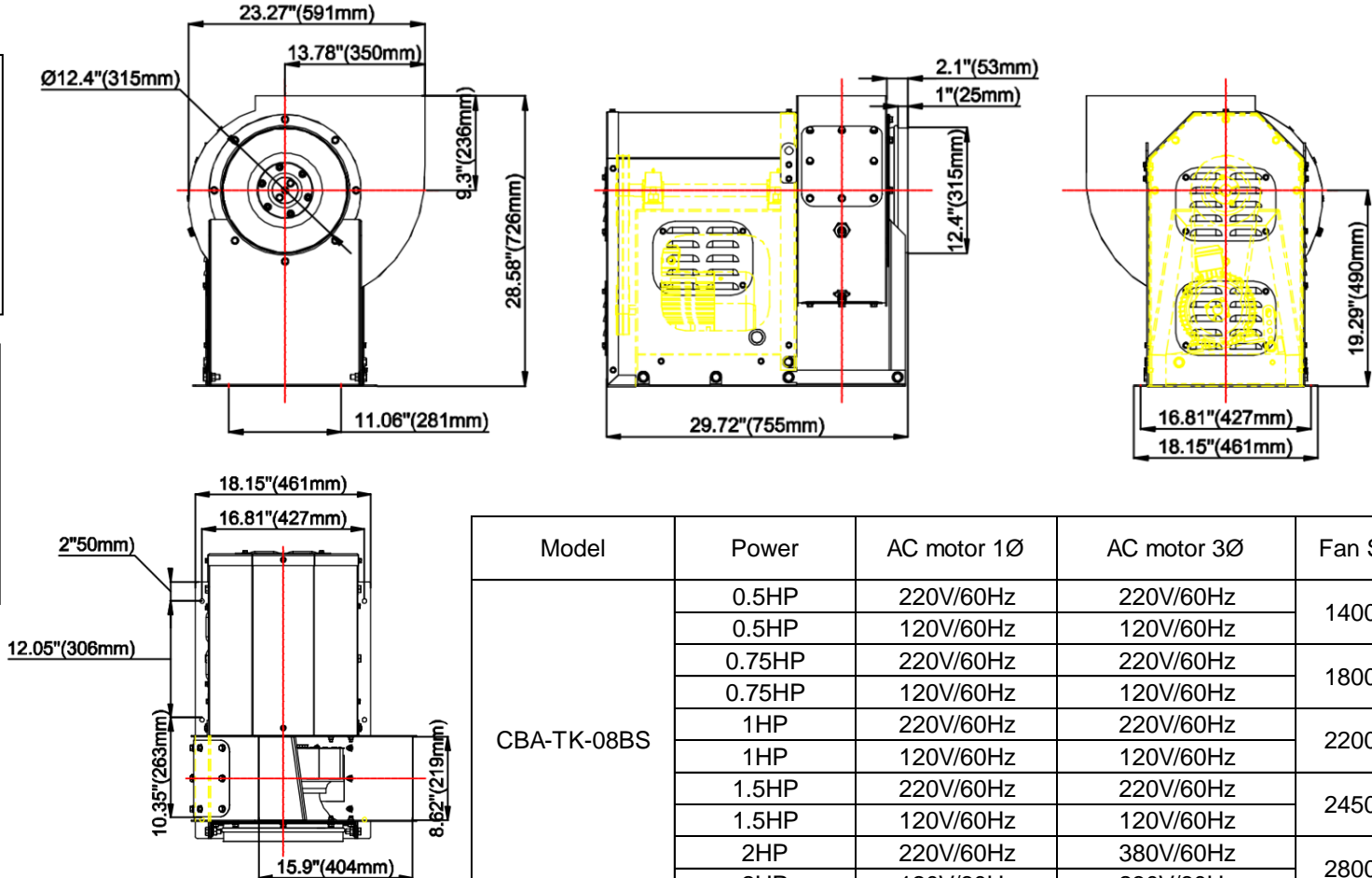

Model	Power	AC motor 1Ø	AC motor 3Ø	Fan Speed
CBA-TK-08BS	0.5HP	220V/60Hz	220V/60Hz	1400RPM
	0.5HP	120V/60Hz	120V/60Hz	
	0.75HP	220V/60Hz	220V/60Hz	1800RPM
	0.75HP	120V/60Hz	120V/60Hz	
	1HP	220V/60Hz	220V/60Hz	2200RPM
	1HP	120V/60Hz	120V/60Hz	
	1.5HP	220V/60Hz	220V/60Hz	2450RPM
	1.5HP	120V/60Hz	120V/60Hz	
	2HP	220V/60Hz	380V/60Hz	2800RPM
	2HP	120V/60Hz	230V/60Hz	

Maximum Speed is 3000rpm

CKS Fan has the right to change the engineering data, design and dimension without prior notice

CFM	Static Pressure in Inches W.G.																	
	0.500		1.000		1.500		2.000		2.500		3.000		3.500		4.000		4.500	
	RPM		RPM		RPM		RPM		RPM		RPM		RPM		RPM		RPM	
	Sone	BHP	Sone	BHP	Sone	BHP	Sone	BHP	Sone	BHP	Sone	BHP	Sone	BHP	Sone	BHP	Sone	BHP
600	802		1152															
	6	0.08	7.9	0.16														
1100	1105		1341		1579		1785		1988		2172		2342		2499			
	8.7	0.17	9.8	0.28	11.4	0.42	13.6	0.56	15.2	0.71	16.5	0.87	17.8	1.03	19	1.2		
1600	1512		1685		1860		2013		2184		2344		2492		2631		2775	
	12.8	0.36	14	0.51	15.7	0.67	16.5	0.84	17.4	1.02	18.4	1.21	19.5	1.41	21	1.62	22	1.83
2100	1957		2092		2223		2358		2488		2610		2724		2856			
	18.4	0.69	19	0.86	19.7	1.05	21	1.26	21	1.47	22	1.69	23	1.91	24	2.16		
2600	2421		2519		2635		2742		2845									
	23	1.2	24	1.39	25	1.62	26	1.85	27	2.1								
3100	2888		2979															
	30	1.91	31	2.17														

Maximum Speed is 3000rpm

CKS Fan has the right to change the engineering data, design and dimension without prior notice.

CBA-TK-10BS

British Standard

Shaft dimension: 1"
 Iron Case Thickness: 16ga
 Motor Bracket Thickness: 14ga
 Approximate Unit weight Thickness
 without motor: 143.3lb

Metric System

Shaft dimension: 28mm
 Iron Case Thickness: 1.5mm
 Motor Bracket Thickness: 2mm
 Approximate Unit weight Thickness
 without motor: 65kg

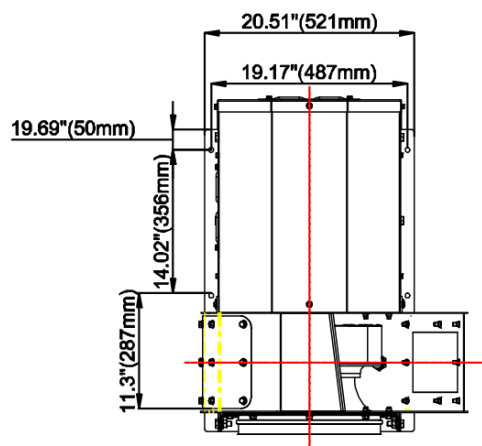
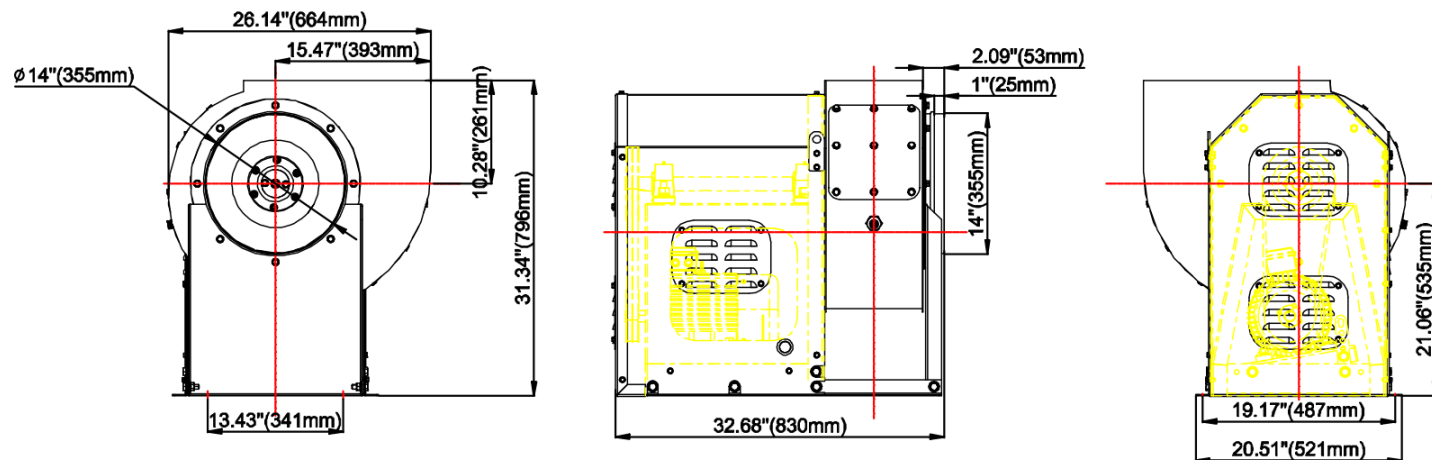

Model	Power	AC motor 1Ø	AC motor 3Ø	Fan Speed
CBA-TK-10BS	0.75HP	220V/60Hz	380V/60Hz	1300RPM
	0.75HP	120V/60Hz	230V/60Hz	
	1HP	220V/60Hz	380V/60Hz	1500RPM
	1HP	120V/60Hz	230V/60Hz	
	1.5HP	220V/60Hz	380V/60Hz	2000RPM
	1.5HP	120V/60Hz	230V/60Hz	
	2HP	220V/60Hz	380V/60Hz	2300RPM
	2HP	120V/60Hz	230V/60Hz	
	3HP	None	380V/60Hz	2800RPM
	3HP		230V/60Hz	

Maximum Speed is 2900rpm

CKS Fan has the right to change the engineering data, design and dimension without prior notice

CFM	Static Pressure in Inches W.G.															
	0.500		1.000		1.500		2.000		2.500		3.000		3.500		4.000	
	RPM		RPM		RPM		RPM		RPM		RPM		RPM		RPM	
	Sone	BHP	Sone	BHP	Sone	BHP	Sone	BHP	Sone	BHP	Sone	BHP	Sone	BHP	Sone	BHP
550	626															
	4.2	0.08														
1050	808		1049		1265		1462		1649		1833					
	6.2	0.16	9.1	0.29	12.1	0.45	15.2	0.63	18.3	0.85	21	1.08				
1575	1074		1272		1444		1602		1753		1897		2036			
	9.6	0.33	12.2	0.5	14.9	0.68	17.6	0.87	20	1.08	23	1.32	25	1.57		
2100	1362		1540		1689		1827		1955		2076		2223		2386	
	15	0.59	16.6	0.82	19	1.05	21	1.28	24	1.52	26	1.77	19.8	1.9	21	2.03
2625	1661		1823		1960		2086		2230		2340		2446		2548	
	20	0.99	20	1.29	21	1.57	21	1.86	22	1.81	22	2.34	23	2.34	24	2.62
3240	2145		2247		2345		2440		2534		2622					
	23	1.44	24	1.72	25	1.99	25	2.26	26	2.54	27	2.83				
3800	2529		2617		2723											
	29	2.19	30	2.53	31	2.76										
4450	2788		2850													
	32	2.89	33	3												

Maximum Speed is 2900rpm

CKS Fan has the right to change the engineering data, design and dimension without prior notice

CBA-TK-14BS

British Standard

Shaft dimension: 1"
 Iron Case Thickness: 14ga
 Motor Bracket Thickness: 12ga
 Approximate Unit weight Thickness without motor: 165.35lb

Metric System

Shaft dimension: 28mm
 Iron Case Thickness: 2mm
 Motor Bracket Thickness: 2.5mm
 Approximate Unit weight Thickness without motor: 75kg

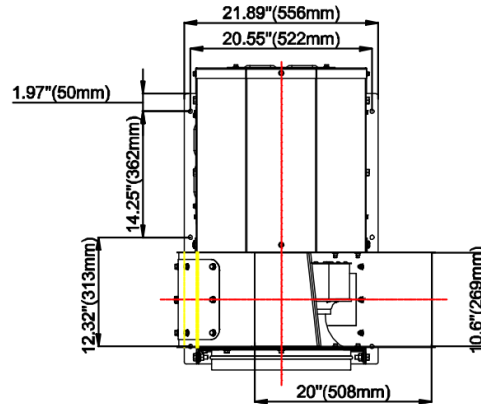
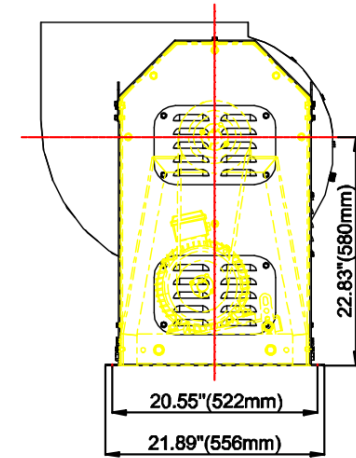
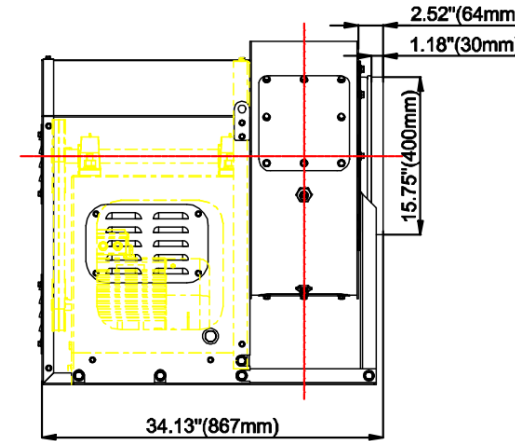
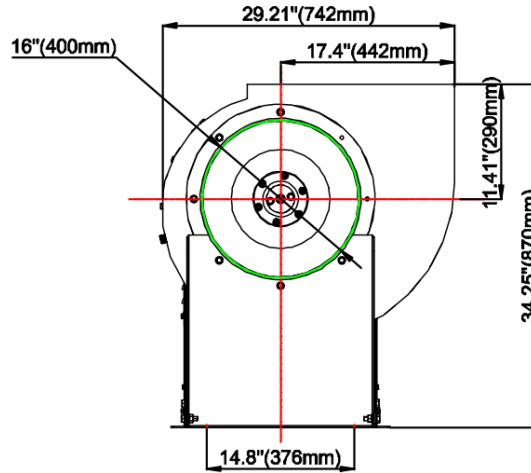

Model	Power	AC motor 1Ø	AC motor 3Ø	Fan Speed
CBA-TK-14BS	0.75HP	220V/60Hz	380V/60Hz	1200RPM
	0.75HP	120V/60Hz	230V/60Hz	
	1HP	220V/60Hz	380V/60Hz	1500RPM
	1HP	120V/60Hz	230V/60Hz	
	1.5HP	220V/60Hz	380V/60Hz	1650RPM
	1.5HP	120V/60Hz	230V/60Hz	
	2HP	220V/60Hz	380V/60Hz	1800RPM
	2HP	120V/60Hz	230V/60Hz	
	3HP	None	380V/60Hz	2100RPM
	3HP		230V/60Hz	
	4HP		380V/60Hz	2400RPM
	4HP		230V/60Hz	

Maximum Speed is 2400rpm

CKS Fan has the right to change the engineering data, design and dimension without prior notice

CFM	Static Pressure in Inches W.G.																	
	0.500		1.000		1.500		2.000		2.500		3.000		3.500		4.000		4.500	
	RPM		RPM		RPM		RPM		RPM		RPM		RPM		RPM		RPM	
	Sone	BHP	Sone	BHP	Sone	BHP	Sone	BHP	Sone	BHP	Sone	BHP	Sone	BHP	Sone	BHP	Sone	BHP
1000	625		866		1069		1248		1408		1554		1691		1818		1941	
	5.5	0.15	8.8	0.29	12.2	0.48	15.6	0.7	18.9	0.93	22	1.19	25	1.47	27	1.76	30	2.06
1500	796		998		1172		1330		1475		1613		1741		1859		1977	
	7.8	0.26	11	0.44	14.1	0.64	17.3	0.87	20	1.12	23	1.4	26	1.69	28	2	31	2.35
2000	992		1168		1321		1461		1592		1715		1831		1943			
	11	0.45	14	0.68	17.1	0.91	19.9	1.16	23	1.43	25	1.72	28	2.02	30	2.35		
2500	1199		1358		1496		1623		1740		1853		1958					
	15.7	0.72	17.8	1	21	1.29	23	1.58	26	1.88	28	2.19	30	2.52				
3000	1412		1560		1686		1802		1910									
	21	1.09	23	1.43	24	1.77	27	2.11	29	2.46								
3500	1630		1767		1886													
	26	1.48	28	1.98	29	2.38												
4000	1851		1981		2109													
	28	2.22	29	2.68	31	2.98												
4500	2080		2144															
	29	2.41	30	2.91														
5200	2316																	
	31	4.01																

Maximum Speed is 2400rpm

CKS Fan has the right to change the engineering data, design and dimension without prior notice

CBA-TK-16BS

British Standard

Shaft dimension: **1.5"**
 Iron Case Thickness: **14ga**
 Motor Bracket Thickness: **12ga**
 Approximate Unit weight Thickness
 without motor: **187.4lb**

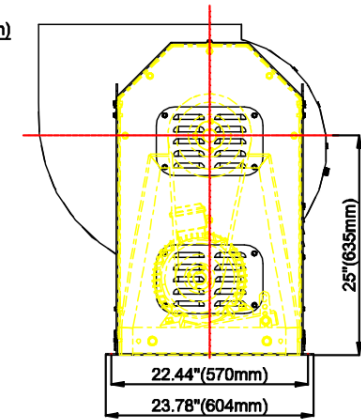
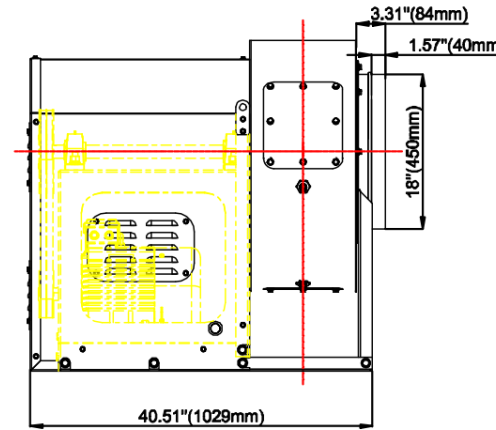
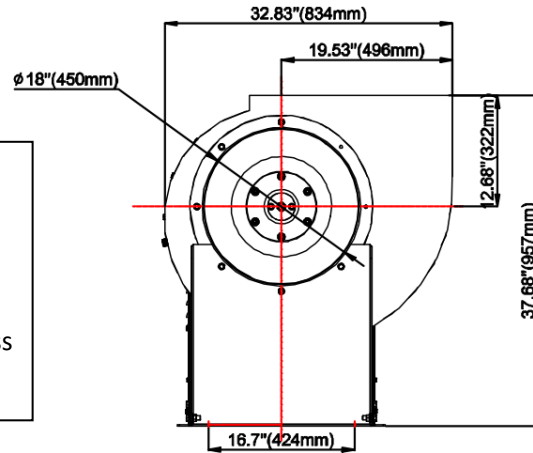

Metric System

Shaft dimension: **38mm**
 Iron Case Thickness: **2mm**
 Motor Bracket Thickness: **2.5mm**
 Approximate Unit weight Thickness
 without motor: **85kg**

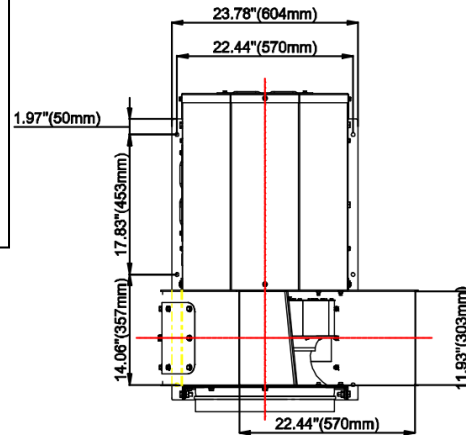

Model	Power	AC motor 1Ø	AC motor 3Ø	Fan Speed
CBA-TK-16BS	0.75HP	220V/60Hz	380V/60Hz	900RPM
	0.75HP	120V/60Hz	230V/60Hz	
	1HP	220V/60Hz	380V/60Hz	1100RPM
	1HP	120V/60Hz	230V/60Hz	
	1.5HP	220V/60Hz	380V/60Hz	1300RPM
	1.5HP	120V/60Hz	230V/60Hz	
	2HP	220V/60Hz	380V/60Hz	1450RPM
	2HP	120V/60Hz	230V/60Hz	
	3HP	None	380V/60Hz	1700RPM
	3HP		230V/60Hz	
	4HP		380V/60Hz	1850RPM
	4HP		230V/60Hz	
	5.5HP	None	380V/60Hz	2000RPM
	5.5HP		230V/60Hz	

Maximum Speed is 2100rpm

CKS Fan has the right to change the engineering data, design and dimension without prior notice

CFM	Static Pressure in Inches W.G.																			
	0.500		1.000		1.500		2.000		2.500		3.000		3.500		4.000		4.500		5.000	
	RPM		RPM		RPM		RPM		RPM		RPM		RPM		RPM		RPM		RPM	
	Sone	BHP	Sone	BHP	Sone	BHP	Sone	BHP	Sone	BHP	Sone	BHP	Sone	BHP	Sone	BHP	Sone	BHP	Sone	BHP
1900	652		853		1026															
	10.1	0.26	11.3	0.49	13.4	0.75														
2375	752		913		1075		1220		1349											
	10.1	0.37	11.6	0.62	13	0.92	15.2	1.24	17.9	158										
2850	864		1000		1135		1270		1397		1513		1620							
	11.5	0.52	12.6	0.8	13.9	1.12	15.5	1.47	18.3	1.85	21	2.24	24	2.65						
3325	982		1101		1217		1334		1447		1562		1669		1768		1861		1950	
	13.6	0.72	14.2	1.03	15.2	1.36	16.8	1.74	19.1	2.15	22	2.58	25	3.02	27	3.48	29	3.95	31	4.43
3800	1108		1212		1313		1415		1516		1617		1718		1817		1910		1998	
	15.7	0.97	16.4	1.32	17.3	1.68	18.7	2.07	21	2.51	23	2.95	25	3.43	27	3.93	29	4.44	32	4.96
4275	1236		1328		1420		1509		1599		1690		1780		1869		1959			
	18.2	1.28	18.8	1.66	19.6	2.07	21	2.48	23	2.92	24	3.41	26	3.9	28	4.42	30	4.96		
4750	1365		1447		1533		1613		1694		1775		1857		1938					
	21	1.66	21	2.08	22	2.52	24	2.97	25	3.43	26	3.91	28	4.45	29	5				
5225	1495		1573		1648		1724		1797		1871		1945							
	24	2.1	24	2.58	25	3.04	26	3.54	27	4.03	28	4.54	30	5.07						
5700	1627		1700		1767		1839		1907		1974									
	27	2.63	28	3.15	28	3.65	29	4.18	30	4.72	31	5.25								
6175	1759		1828		1892		1955		2021											
	31	3.26	31	3.81	31	4.37	32	4.92	33	5.49										
6650	1893		1957		2028															
	34	3.98	35	4.57	35	5.18														

Maximum Speed is 2100rpm

CKS Fan has the right to change the engineering data, design and dimension without prior notice

CBA-TK-18BS

British Standard

Shaft dimension: **1.5"**
 Iron Case Thickness: **14ga**
 Motor Bracket Thickness: **11ga**
 Approximate Unit weight Thickness without motor: **220.46lb**

Metric System

Shaft dimension: **38mm**
 Iron Case Thickness: **2mm**
 Motor Bracket Thickness: **3mm**
 Approximate Unit weight Thickness without motor: **100kg**

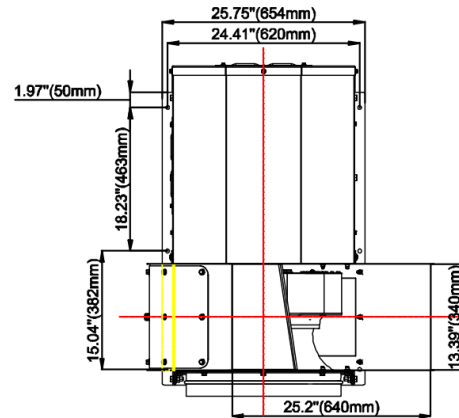
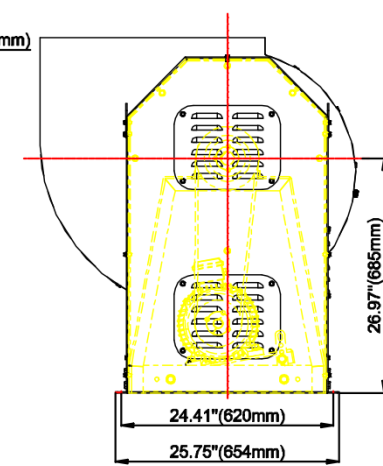
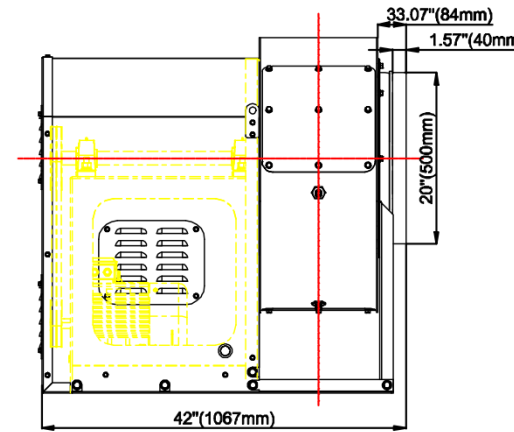
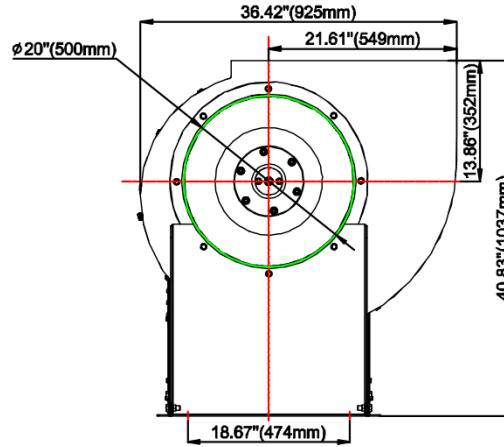

Model	Power	AC motor 1Ø	AC motor 3Ø	Fan Speed
CBA-TK-18BS	1HP	220V/60Hz	380V/60Hz	900RPM
	1HP	120V/60Hz	230V/60Hz	
	1.5HP	220V/60Hz	380V/60Hz	1100RPM
	1.5HP	120V/60Hz	230V/60Hz	
	2HP	220V/60Hz	380V/60Hz	1300RPM
	2HP	120V/60Hz	230V/60Hz	
	3HP	None	380V/60Hz	1500RPM
	3HP		230V/60Hz	
	4HP		380V/60Hz	1650RPM
4HP	230V/60Hz			

Maximum Speed is 1700rpm

CKS Fan has the right to change the engineering data, design and dimension without prior notice

CFM	Static Pressure in Inches W.G.																	
	0.500		1.000		1.500		2.000		2.500		3.000		3.500		4.000		4.500	
	RPM		RPM		RPM		RPM		RPM		RPM		RPM		RPM		RPM	
	Sone	BHP	Sone	BHP	Sone	BHP	Sone	BHP	Sone	BHP	Sone	BHP	Sone	BHP	Sone	BHP	Sone	BHP
1980	452		653		826													
	10.1	0.26	11.3	0.49	13.4	0.75												
2465	552		713		875		1020		1149									
	10.1	0.37	11.6	0.62	13	0.92	15.2	1.24	17.9	1.58								
2970	664		800		935		1070		1197		1313		1420					
	11.5	0.52	12.6	0.8	13.9	1.12	15.5	1.47	18.3	1.85	21	2.24	24	2.65				
3465	782		901		1017		1133		1247		1362		1469		1568		1661	
	13.6	0.72	14.2	1.03	15.2	1.36	16.8	1.74	19.1	2.15	22	2.58	25	3.02	27	3.48	29	3.95
3960	908		1012		1113		1215		1316		1417		1518		1617			
	15.7	0.97	16.4	1.32	17.3	1.68	18.7	2.07	21	2.51	23	2.95	25	3.33	27	3.93		
4950	1165		1247		1333		1413		1494		1575		1657					
	21	1.66	21	2.08	22	2.52	24	2.97	25	3.43	26	3.91	28	4.45				
5445	1295		1373		1448		1524		1597		1671							
	24	2.1	24	2.58	25	3.04	26	3.04	27	4.03	28	4.54						
5940	1427		1500		1567		1639		1707									
	27	2.63	28	3.15	28	3.65	29	4.18	30	4.72								
6435	1559		1628		1692													
	31	3.26	31	3.81	31	4.37												
6930	1693																	
	34	3.98																

Maximum Speed is 1700rpm

CKS Fan has the right to change the engineering data, design and dimension without prior notice

CBA-TK-20BS

British Standard

Shaft dimension: 1.5"
 Iron Case Thickness: 12ga
 Motor Bracket Thickness: 11ga
 Approximate Unit weight Thickness without motor: 231.5lb

Metric System

Shaft dimension: 42mm
 Iron Case Thickness: 2.5mm
 Motor Bracket Thickness: 3mm
 Approximate Unit weight Thickness without motor: 105kg

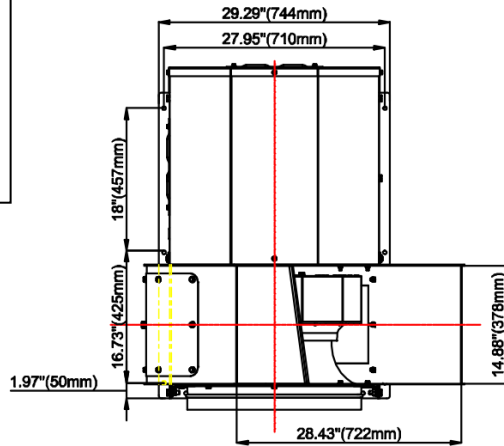
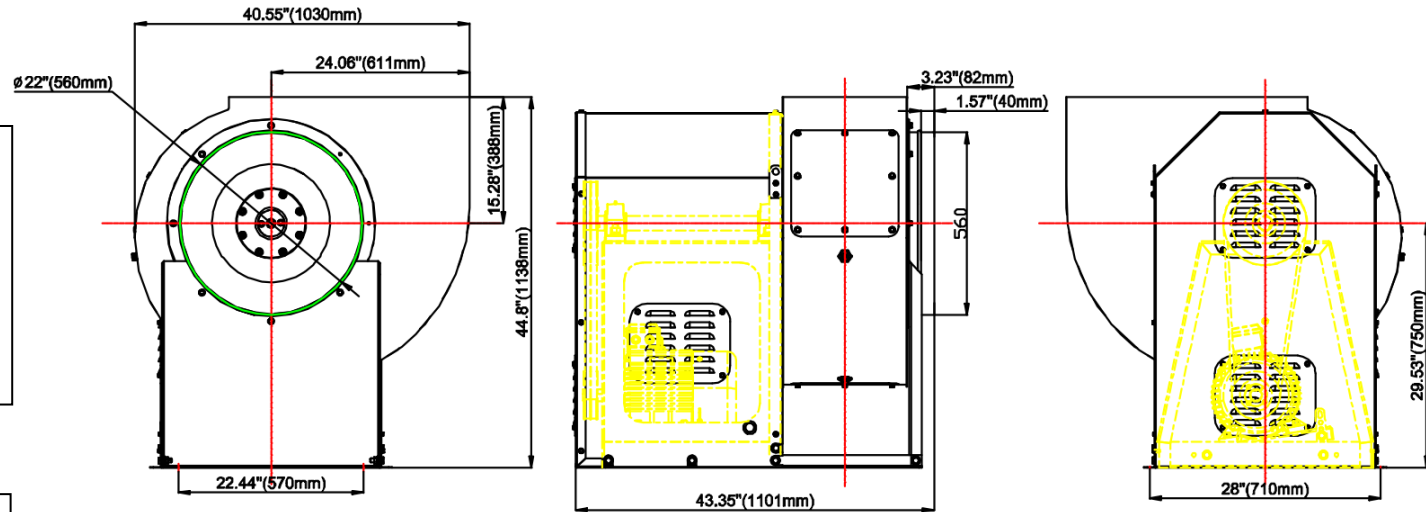

Model	Power	AC motor 1Ø	AC motor 3Ø	Fan Speed
CBA-TK-20BS	1.5HP	220V/60Hz	380V/60Hz	950RPM
	1.5HP	120V/60Hz	230V/60Hz	
	2HP	220V/60Hz	380V/60Hz	1050RPM
	2HP	120V/60Hz	230V/60Hz	
	3HP	None	380V/60Hz	1150RPM
	3HP		230V/60Hz	
	4HP		380V/60Hz	1300RPM
	4HP		230V/60Hz	
	5.5HP		380V/60Hz	1450RPM
	5.5HP		230V/60Hz	

Maximum Speed is 1500rpm

CKS Fan has the right to change the engineering data, design and dimension without prior notice

CFM	Static Pressure in Inches W.G.																	
	0.500		1.000		1.500		2.000		2.500		3.000		3.500		4.000		4.500	
	RPM		RPM		RPM		RPM		RPM		RPM		RPM		RPM		RPM	
	Sone	BHP	Sone	BHP	Sone	BHP	Sone	BHP	Sone	BHP	Sone	BHP	Sone	BHP	Sone	BHP	Sone	BHP
2400	442		623		789													
	9.3	0.3	11.5	0.59	14.3	0.93												
3100	517		671		811		939		1066									
	9.7	0.43	11.5	0.77	13.8	1.15	16.6	1.56	20	2.01								
3800	608		732		859		977		1081		1187		1292					
	11.2	0.61	12.6	0.99	14.3	1.43	16.8	1.88	20	2.36	24	2.88	27	3.42				
4500	708		815		920		1026		1129		1223		1310		1396		1488	
	13.6	0.86	14.2	1.27	15.6	1.75	17.7	2.27	21	2.8	24	3.36	27	3.92	29	4.52	32	5.16
5250	816		905		1000		1089		1179		1372		1358		1438		1514	
	15.8	1.18	16.5	1.64	17.5	2.14	19.5	2.7	22	3.3	25	3.91	27	4.54	30	5.18	32	5.84
6000	925		1004		1084		1166		1245		1327		1407		1487			
	18.4	1.6	19	2.09	20	2.64	22	3.22	24	3.85	26	4.53	28	5.22	30	5.92		
6650	1037		1107		1179		1250		1324		1393		1479		1518			
	21	2.1	22	2.66	23	3.23	25	3.85	26	4.52	27	5.2	29	5.95	31	6.73		
7400	1150		1216		1279		1343		1408		1475							
	25	2.71	25	3.32	26	3.95	27	4.61	28	5.3	30	6.03						
8100	1264		1325		1382		1441		1499									
	29	3.43	29	4.12	29	4.8	30	5.47	31	6.22								
8800	1379		1436		1490		1443											
	32	4.28	32	5.04	33	5.77	34	6.51										
9500	1495																	
	36	5.28																

Maximum Speed is 1500rpm

CKS Fan has the right to change the engineering data, design and dimension without prior notice

CBA-TK-24BS

British Standard

Shaft dimension: 1.5"
 Iron Case Thickness: 12ga
 Motor Bracket Thickness: 11ga
 Approximate Unit weight Thickness
 without motor: 319.67lb

Metric System

Shaft dimension: 42mm
 Iron Case Thickness: 2.5mm
 Motor Bracket Thickness: 3mm
 Approximate Unit weight Thickness
 without motor: 145kg

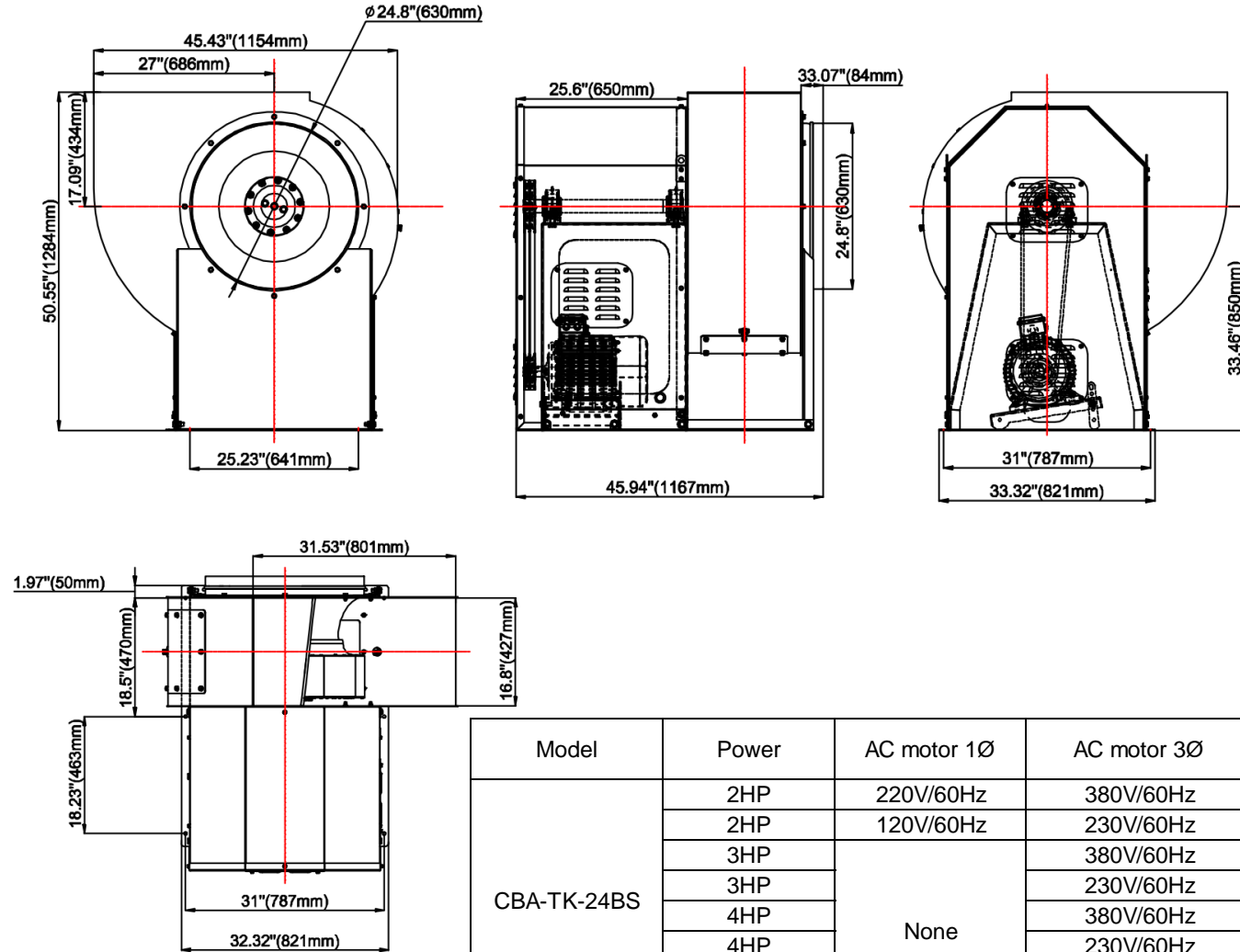

Model	Power	AC motor 1Ø	AC motor 3Ø	Fan Speed
CBA-TK-24BS	2HP	220V/60Hz	380V/60Hz	800RPM
	2HP	120V/60Hz	230V/60Hz	
	3HP	None	380V/60Hz	900RPM
	3HP		230V/60Hz	
	4HP		380V/60Hz	1000RPM
	4HP		230V/60Hz	
	5.5HP	None	380V/60Hz	1200RPM
	5.5HP		230V/60Hz	

Maximum Speed is 1250rpm

CKS Fan has the right to change the engineering data, design and dimension without prior notice

CFM	Static Pressure in Inches W.G.																	
	0.500		0.750		1.000		1.500		2.000		2.500		3.000		3.500		4.000	
	RPM		RPM		RPM		RPM		RPM		RPM		RPM		RPM		RPM	
	Sone	BHP	Sone	BHP	Sone	BHP	Sone	BHP	Sone	BHP	Sone	BHP	Sone	BHP	Sone	BHP	Sone	BHP
3000	416		504		589													
	7.4	0.34	9.1	0.51	12.7	0.71												
3900	484		549		616		751											
	8.5	0.5	9.4	0.68	10.4	0.89	14.5	1.37										
4800	564		619		673		780		891		996							
	10	0.71	11	0.92	11.7	1.14	13.2	1.64	16.1	2.2	18.9	2.84						
5700	650		699		746		835		926		1016		1111		1199			
	12.4	1	13	1.24	13.5	1.49	14.7	2.01	16.5	2.6	19.1	3.22	22	3.95	25	4.72		
6600	741		784		826		905		983		1061		1141		1219		1250	
	14.5	1.36	15.2	1.64	15.8	1.92	17	2.49	18.2	3.11	20	3.77	23	4.49	25	5.24	27	6.1
7500	836		872		910		983		1052		1120		1190		1259			
	17.1	1.82	17.8	2.13	18.6	2.44	19.7	3.09	21	3.74	22	4.45	24	5.19	26	5.98		
8400	931		966		998		1065		1130		1191		1252					
	20	2.38	21	2.73	22	3.08	23	3.79	24	4.51	25	5.24	25	6.03				
9300	1029		1060		1090		1151		1210									
	24	3.07	25	3.44	25	3.83	27	4.61	27	5.39								
10200	1129		1156		1184		1238											
	28	3.89	29	4.29	29	4.71	30	5.55										
11100	1229		1254															
	31	4.85	32	5.28														

Maximum Speed is 1250rpm

CKS Fan has the right to change the engineering data, design and dimension without prior notice

CBA Notes

- Please check all the parts of the body in details and make sure whether there is damage inside or not. It is because the fan may be damage during the transportation. If any, it should be repaired before it install
- The motor and impeller should connect properly, and its protection level is IP54, insulation class is F.
- Please do check the fan and duct, and ensure that there are no obstructions to hinder the rotation. If any, it should be cleared before starting
- Running in a given value and the fan should be rotate in a given direction
- If any unexpected sound and strenuous vibration occurred, please switch off the blower and repair the breakdown before it use.
- The fan cannot bear the weight of duct and it needs to provide an extra bearing frame to bearing.

General Questions

Did not rotate

- Wrong Voltage
- Power shut down or wrong wiring
- Overload protection
- Fuse burn-out.
- Loose of pulley.
- Failure of belt

Limited Air Volume

- Wrong rotate direction.
- The real air speed is lower than expected
- Static pressure is too much
- Restricted Inlet or Outlet
- Blocked Inlet or Outlet

Too much Air Volume

- The real air speed is higher than expected
- Static pressure is too less
- The blower is not installed in the right position

Company Introduction

CKS FangYuan Industry is China based business owned and operated by its management team. We specialize in air movement and have experience gained more than ten years of operation with worldwide predecessors. We service the ventilation equipment needs of customers ranging from HVAC through mining, manufacturing, construction, and agriculture as well as retail end users include Tianjin and Suzhou retail stores. We build our products in state of the art facilities in Guangzhou, WuHan and DeQing. We adapt ISO9001 quality system to ensure our customers are using best products.

Capabilities and Services

1. Fan and Blower design and manufacture
2. Fully performance tested products and published data
3. In-house design engineering team
4. Scale and capacity to handle any size project
5. Servicing overseas markets with built products and OEM supply
6. Sales and after sales support teams



Guangzhou

Tel: +86 (020) 87481162

Fax: +86 (020) 87481612

China

Certification:



国家防爆



Guangzhou AoZhong Fan Equipment Co.,LTD

